

**39,844 SF**  
**Retail Center**

**Marsh Creek Village**  
**Shopping Center**

6780 Roswell Road, Atlanta, GA 30328

**FULLY LEASED**



**Property Highlights**

- Marsh Creek Village Shopping Center; Buildings C and D are now fully leased.
- Great location in Sandy Springs with strong visibility and over 600 feet of frontage on Roswell Road
- Buildings built in 2010, Easy Ingress/Egress
- Over 30,000 cars per day pass by on Roswell Road

<b>KEY FACTS</b>		<b>ROSWELL ROAD TRAFFIC COUNT</b>	<b>ANNUAL GROWTH RATE</b>
2.1 Average Household Size	93,955 Population	32,800 Per Day	1.5%
<b>BUSINESS</b>		<b>INCOME</b>	
175,200 Total Daytime Population	134,380 Total Employees	\$ 87,286 Median Household Income	\$60,566 Per Capita Income

The information contained herein has been received from sources considered reliable, but no liability is assumed by Richard Bowers & Co. or its Agents for errors and omissions.



**Richard Bowers & Co.**  
260 Peachtree Street | Suite 2400  
Atlanta, GA 30303  
(404) 816-1600  
www.richardbowers.com



**For More Information contact**

**Exclusive Agent:**

**Jeff McMullen**  
(770) 380-6538 - Mobile  
jmcullen@richardbowers.com

**39,844 SF**  
**Retail Center**

**Marsh Creek Village**  
**Shopping Center**  
6780 Roswell Road, Atlanta, GA 30328

**SPACE FLOOR PLAN**

**BLDG C – 1<sup>st</sup> Floor**



**BLDG D – 1<sup>st</sup> Floor**

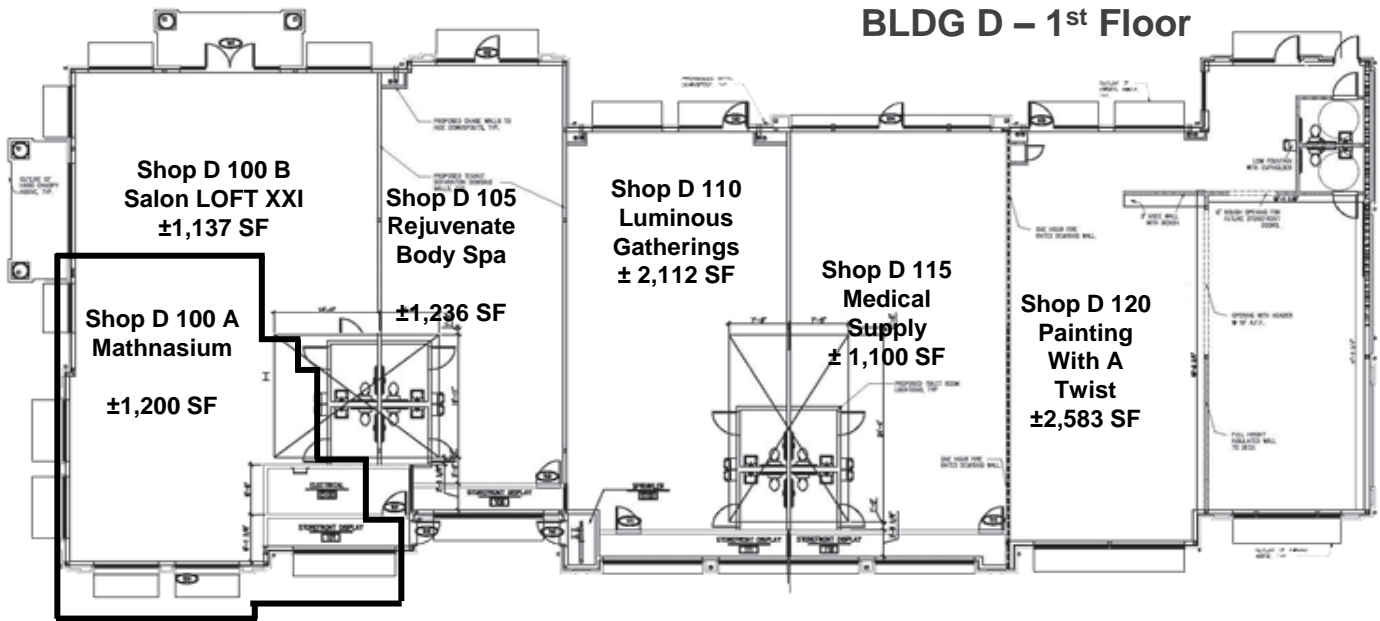

The information contained herein has been received from sources considered reliable, but no liability is assumed by Richard Bowers & Co. or its Agents for errors and omissions.



**Richard Bowers & Co.**  
260 Peachtree Street | Suite 2400  
Atlanta, GA 30303  
(404) 816-1600  
www.richardbowers.com



**For More Information contact**

**Exclusive Agent:**

**Jeff McMullen**  
(770) 380-6538 - Mobile  
jmcullen@richardbowers.com