

Office Condo For Lease

1,100 SF

620 Peachtree Street
Suite 311-A
Atlanta, GA 30308



Property Highlights

- Mezzanine Level: Suite 311-A
- Approximately 1,100 SF
- Rental Rate: \$22.00 PSF, Net of Janitorial
- Long-term Stable Ownership
- Secure Parking Available in Attached Deck with Limited Free Visitor Parking
- Excellent Midtown Location
- One Block to North Avenue MARTA Station



Richard Bowers & Co.
260 Peachtree Street | Suite 2400
Atlanta, GA 30303
(404) 816-1600
www.richardbowers.com



For More Information contact:

Dave Morgan GREC # 123478
404-816-1600 Ext. 119
dmorgan@richardbowers.com

**Office Condo
For Lease**
1,100 SF

**620 Peachtree Street
Suite 311-A**
Atlanta, GA 30308

Floor Plan

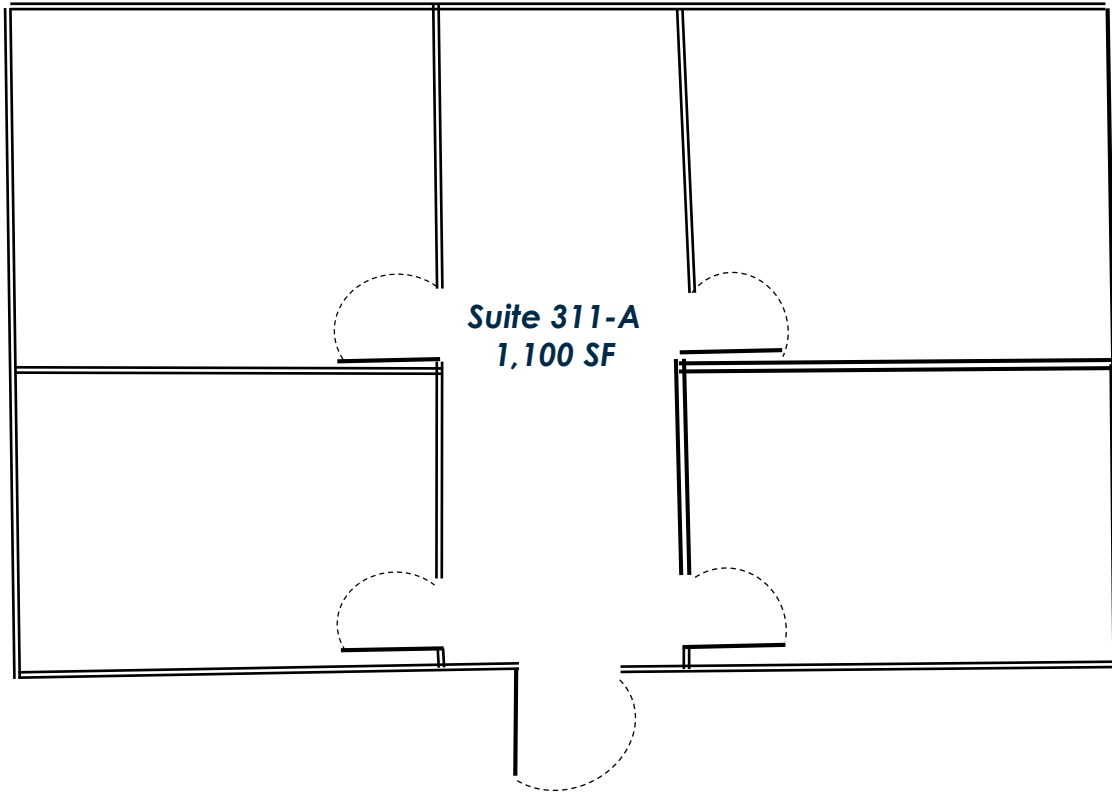

Richard Bowers & Co.
260 Peachtree Street | Suite 2400
Atlanta, GA 30303
(404) 816-1600
www.richardbowers.com



For More Information contact:

Dave Morgan GREC # 123478
404-816-1600 Ext. 119
dmorgan@richardbowers.com