

Office Condo For Lease 1,000 SF

620 Peachtree Street
Suite 300-D
Atlanta, GA 30308



Property Highlights

- Mezzanine Level: Suite 300-D
- Approximately 400 SF
- Immediate Occupancy
- Rental Rate: \$1,000.00 Per Month, Net of Janitorial
- Long-term Stable Ownership
- Secure Parking Available in Attached Deck with Limited Free Visitor Spaces
- Excellent Midtown Location
- One block to North Avenue MARTA Station



The information contained herein has been received from sources deemed reliable, but no liability is assumed by Richard Bowers & Co. or its agents for errors or omissions.



Richard Bowers & Co.
260 Peachtree Street | Suite 2400
Atlanta, GA 30303
(404) 816-1600
www.richardbowers.com



For More Information contact:

Dave Morgan, VP
404-816-1600 Ext. 119
dmorgan@richardbowers.com

Office Condo For Lease 1,000 SF

620 Peachtree Street Suite 300-D Atlanta, GA 30308

Floor Plan

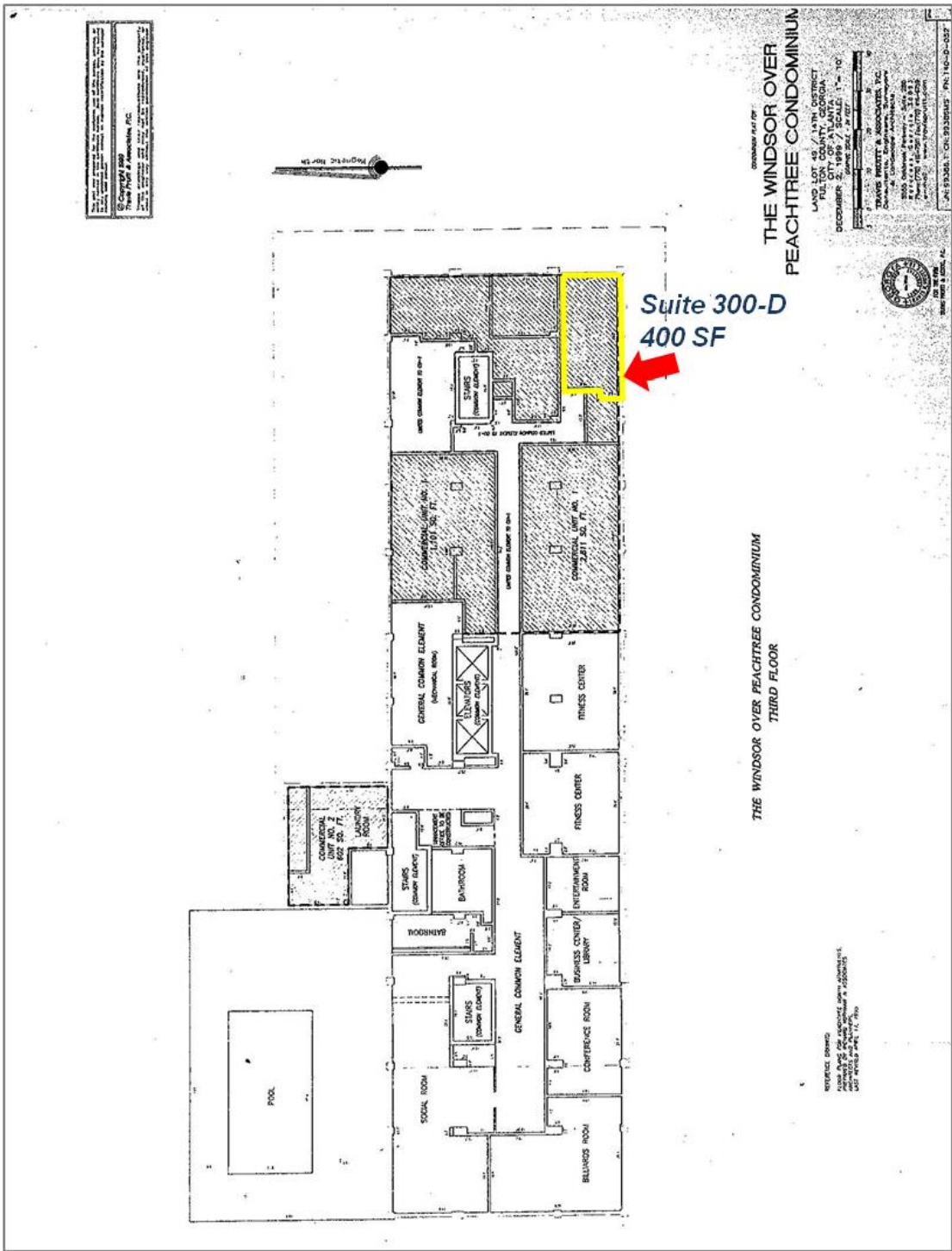

The information contained herein has been received from sources deemed reliable, but no liability is assumed by Richard Bowers & Co. or its agents for errors or omissions.



Richard Bowers & Co.
260 Peachtree Street | Suite 2400
Atlanta, GA 30303
(404) 816-1600
www.richardbowers.com



For More Information contact:

Dave Morgan, VP
404-816-1600 Ext. 119
dmorgan@richardbowers.com