

# 2650 Pleasantdale Road #1

Doraville, GA 30340

± 3,150 SF

**SUBLEASE**

Office/  
Warehouse



## Pleasantdale Center Highlights:

- Rental Rate Negotiable
- ± 3,150 SF Office/Warehouse
- Term Expires September 30, 2021
- Ideal access to I-85, I-285, Buford Hwy & Jimmy Carter Blvd.
- Zoning: M-1 (Flex)
- Sprinklered



## Exclusive Agents:

**Randy Hoye**

Office: 404-816-1600 Cell 404-295-0908

[rhoye@richardbowers.com](mailto:rhoye@richardbowers.com)

**Jeff McMullen**

Office: 404-816-1600 Cell 770-380-6538

[jmcmullen@richardbowers.com](mailto:jmcmullen@richardbowers.com)



**Richard Bowers & Co.**  
Real Estate



[www.richardbowers.com](http://www.richardbowers.com)

260 Peachtree Street, Suite 2400, Atlanta, GA 30303 | Phone (404) 816-1600 | Fax (404) 880-0077

The information contained herein has been received from sources deemed reliable but no liability is assumed by Richard Bowers & Co. or its agents for errors or omissions.

# 2650 Pleasantdale Road #1

Doraville, GA 30340

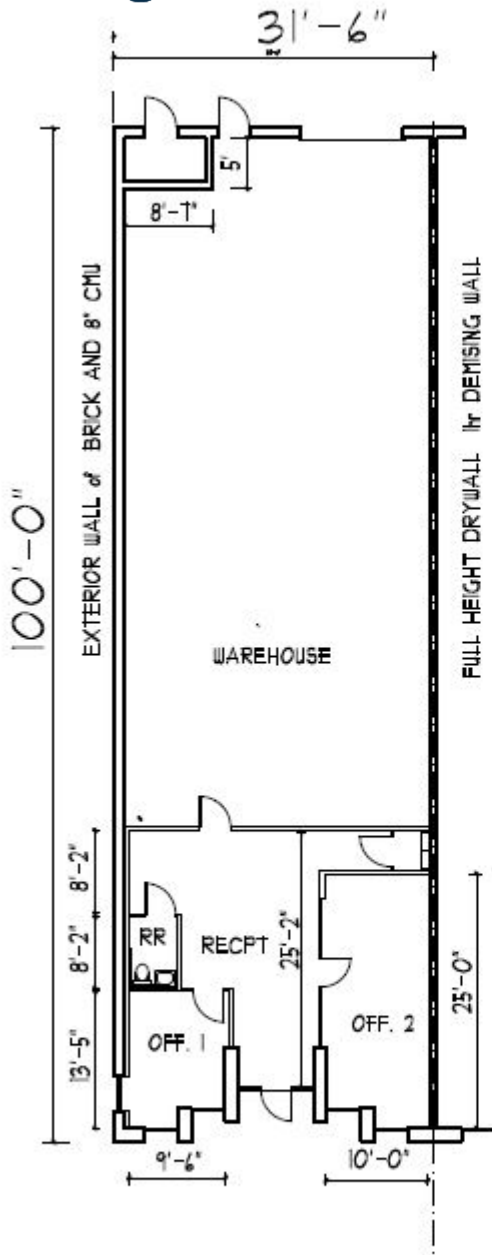

2650  
PLEASANTDALE  
ROAD  
DORAVILLE GA 30340

SUITE 1

SUITE 1	
OFFICE	875
WAREHOUSE	2,598
<b>TOTAL</b>	<b>3,150</b>

KEY PLAN

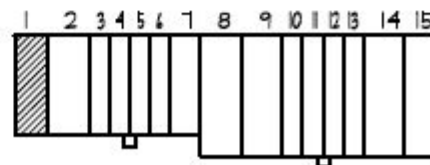

[www.richardbowers.com](http://www.richardbowers.com)

260 Peachtree Street, Suite 2400, Atlanta, GA 30303 | Phone (404) 816-1600 | Fax (404) 880-0077

