

# Peachtree Towers

300 Peachtree Street Atlanta, GA 30303

±1,800 SF

For Lease

Retail Space



## Property Highlights

- Ground floor retail space
- Prime Downtown location
- Ideal location for a service business
- Parking deck close by
- Peachtree Street address
- 8,000,000 SF of office space within 4 blocks
- 99,764 Number of people within 2 miles
- Signage opportunities
- Across the street from the Hyatt Regency Hotel

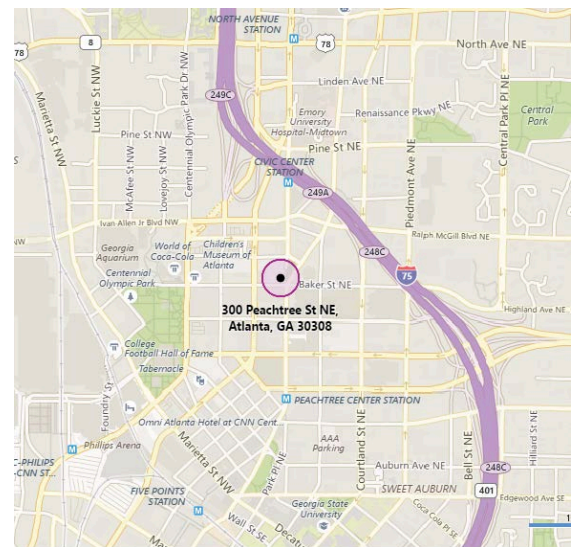

## Exclusive Agents

**Willie Ellington**  
404.816.1600 Ext. 148  
wellington@richardbowers.com

**Jeff McMullen**  
404.816.1600 Ext. 145  
jmcullen@richardbowers.com



[www.richardbowers.com](http://www.richardbowers.com)

260 Peachtree Street, Suite 2400, Atlanta, GA 30303 | Phone (404) 816-1600 | Fax (404) 880-0077

The information contained herein has been received from sources deemed reliable but no liability is assumed by Richard Bowers & Co. or its agents for errors or omissions.

© COPYRIGHT 2015 FACILITEC, INC.  
 ALL RIGHTS RESERVED. NO PART OF THIS DOCUMENT MAY BE REPRODUCED OR TRANSMITTED IN ANY FORM OR BY ANY MEANS, ELECTRONIC OR MECHANICAL, WITHOUT PERMISSION IN WRITING FROM FACILITEC, INC.

**FACILITEC**  
 WORKING SPACES | CONTROLLED COSTS  
 300 PEACHTREE STREET  
 ATLANTA, GA 30303  
 (404) 818-0984  
 BLTTE 201

**NAME OF COMPANY**  
 300 Peachtree Street  
 Atlanta, GA 30303  
 1,750 SF

**DRAWN BY:**  
**JOB #:**  
**RSF:**

REV	DATE	DESCRIPTION
	07/08/15	PRELIMINARY SPACE PLAN

PRELIMINARY PLAN  
 SHEET NO.  
**P-1**  
 SHEET NO.

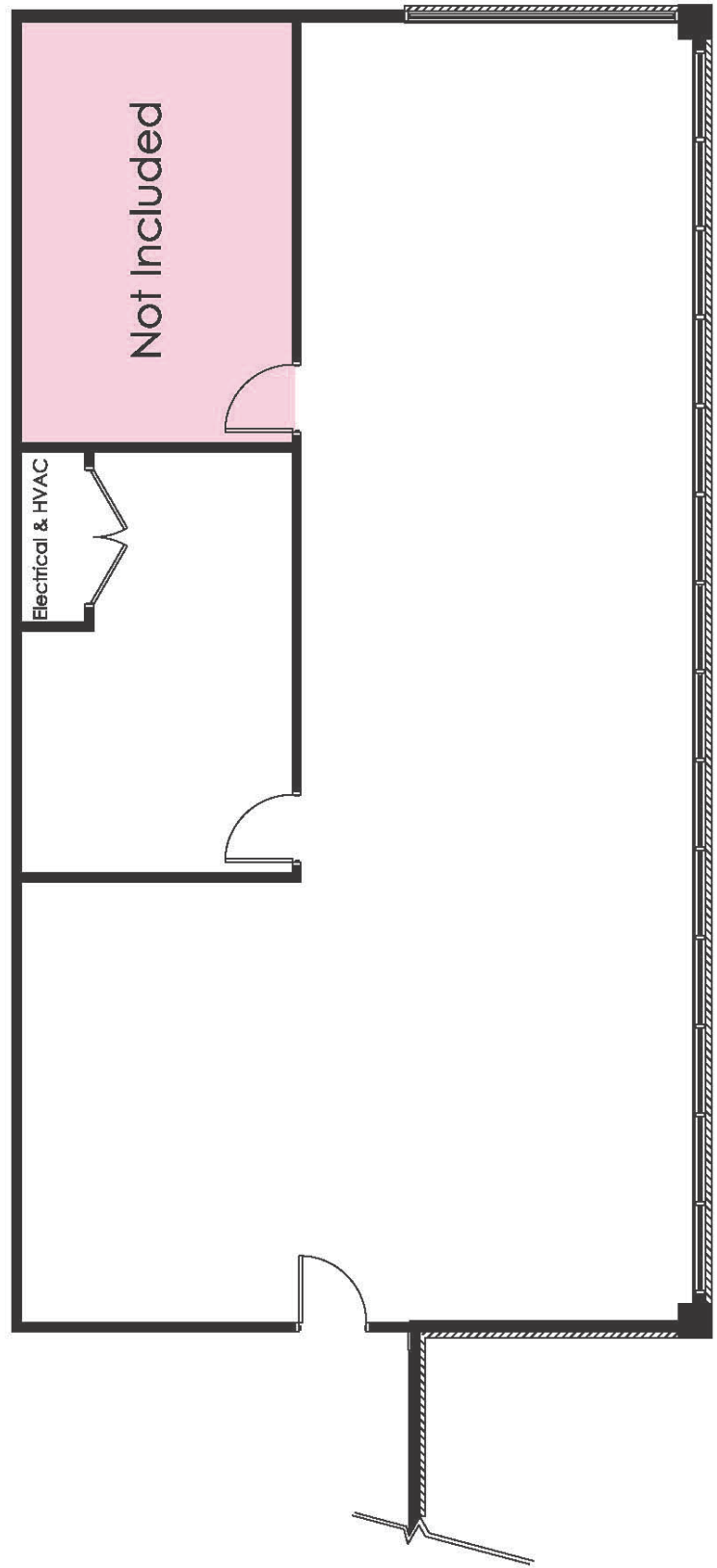

**1 PRELIMINARY PLAN**  
 SCALE : 1/8" = 1'-0"

PARTITION TYPE	PARTITION LEGEND
E-1	Existing Building Standard Partition to Remain
ER	Existing Building Standard Partition to be Removed
E1-A	Existing 1-Hour Rated Building Standard Partition, Verify and Upgrade as Required
T-1	New Building Standard Ceiling Height Partition
T-5	Exterior Partition to Remain

Note: This is a master list, not all wall types may be used on project. Refer to dimensioned partition plan for partition locations

**NOTE:**  
 THIS PLAN WAS DRAWN WHO THE BENEFIT OF AN ON SITE FIELD VERIFICATION. PRIOR TO CONSTRUCTION, FACILITEC, INC. RECOMMENDS THAT A VERIFICATION IS COMPLETED. IT WILL BE THE RESPONSIBILITY OF THE G.C. TO NOTIFY FACILITEC, INC. OF ANY PROBLEMS. FACILITEC, INC. SHALL NOT BE HELD RESPONSIBLE FOR ANY CODE INFRACTIONS DUE TO THIS MATTER.  
 ANY FURNITURE OR EQUIPMENT SHOWN IS NOT AND ONLY SHOWN FOR PLANNING PURPOSES.

PLEASE INDICATE THAT YOU HAVE REVIEWED THIS DOCUMENT CAREFULLY AND FIND THESE SPECIFICATIONS AND INTENTIONS AS APPROVED FOR CONSTRUCTION BY SIGNING YOUR NAME AND DATING BELOW.  
 SIGNED BY: \_\_\_\_\_ DATE: \_\_\_\_\_